



Mercury Skeg Control Unit assembly manual

How to take apart and reassemble the skeg control unit



If the skeg on your Mercury doesn't come out, the problem is most likely located in the skeg control unit. But to check it you will need to take it apart



1. To take apart the Skeg control unit, you will need two tools:
 1. Plier with thin jaws at the tip
 2. A short Screw driver with phillips head

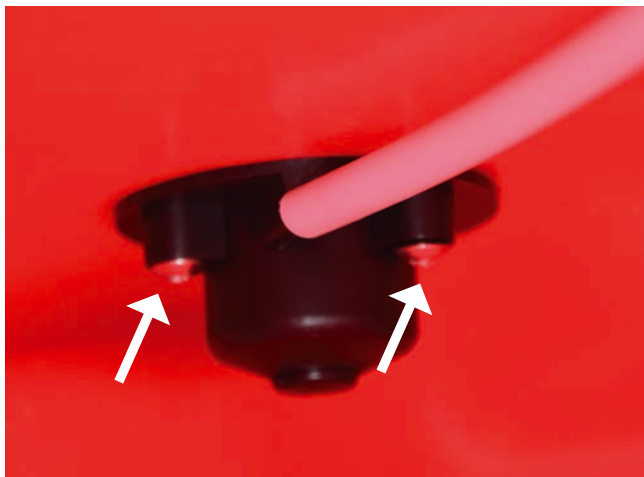

2. You start by taking apart the skeg control unit inside the back section of the kayak. open the hatch and you will see the control unit is attached with 3 screws under the deck

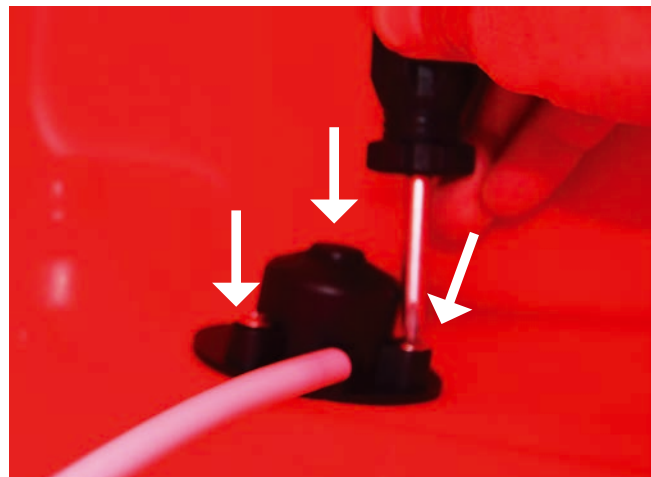

3. If you stand the aft section on its end, it will be easier for you to reach the screws. Use the short Phillips screw driver, and unscrew the 3 screws inside the section



4. When the screws have been loosened you can pull out the skeg control unit out of the deck

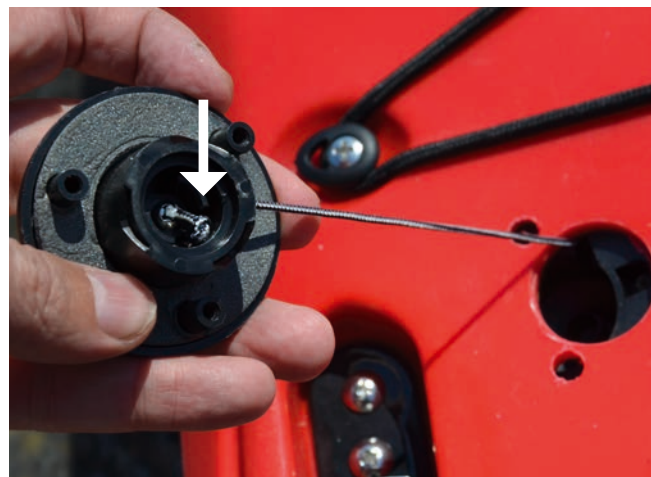

5. Pull out the Skeg control unit as far as possible. You will need to unwind the line inside the unit by twisting the control until the hole for the line outside the unit and the knot are aligned. On this image the line is much too long. This will make it jam inside the unit as it needs to be wound up several revolutions around the unit.



6. A different reason could be that there is too much line after the knot, which also might jam the mechanism



7. To make the line shorter, you should pull out the line with the plyer and undo the knot



8. Pull the line as much as possible (make sure the skeg is up in the rudder, and make a new knot as close to the unit as possible



9. This is the correct length bot inside and outside the unit



10. Place the control unit over the hole on the deck. Make sure the hole where the line comes out is facing backwards to line it up with the skeg tube inside.



11 Push the control unit through the holes and keep pressure on it, while aligning the bottom of the unit inside the back section. Again this will be easier to access if the section is standing up. Screw on the 3 screws inside the section. The skeg should now be able to come out by itself.